

## NX2 Modular Steel Shelters featuring StrutLock Construction

**Solarcraft's rugged shelter designed for easy integration and true thermal efficiency**

Solarcraft NX2 shelter walls and roof panels support heavy equipment on StrutLock integrated channel struts. The double-faced steel wall and roof panels have integrated channel strut on all interior and exterior surfaces.

Install equipment directly onto StrutLock channels; no need for conventional attachment methods that require anchor bolts drilled into the steel wall. Equipment additions and change-outs are simple. Remove and reposition with channel connections.

Energy efficiency and R-Value 15: NX2 shelters feature wall and roof panels that are insulated with 5 inches of fire resistant rock wool material. Every back-to-back channel strut is insulated with high composite material to defeat thermal transfer. The result is maximum thermal efficiency, saving energy over the lifetime of the shelter.

### StrutLock Integrated Channel Struts

- StrutLock integrated channel struts recessed between each panel for fast and flexible equipment installation
- Hard attachment points every 24", inside and out
- Offers flexibility to reposition components within the enclosure without perforating wall panels
- Higher weight load bearing than drilled anchor bolts typical of stick-and-wall construction

### R-15 Rated Thermal Efficiency

- True thermal efficiency with an overall R-value of R-15
- Patented high-composite insulated design with 5" thick fire-resistant rock wool insulation
- Back-to-back channel struts insulated with high-composite material between them to defeat thermal transfer
- Reduces utility power consumption over the life of the shelter, providing you with valuable cost savings

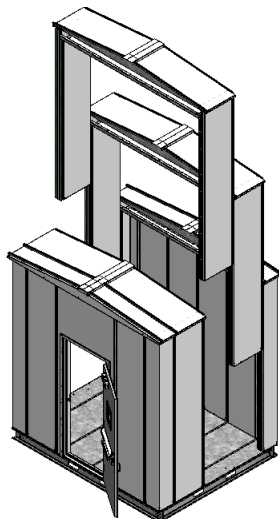

### Modular Design for Custom Solutions

- Interchangeable 2' panels assembled to meet your specific requirements
- Width 8', 10', 12'; Height 8', 10'; Depth in N x 2-foot increments
- Pre-fabricated panels for HVAC, ventilation, interior seal walls, pipe bulkheads, doors, and windows
- Riveted, not welded, panel connections for quick fabrication



NX2 Shelters are proudly made in the USA by Solarcraft, Inc.

877.340.1224 toll free | [www.solarcraft.net](http://www.solarcraft.net)

12300 Dairy Ashford Road Ste 100 | Sugar Land, TX 77478 | USA

## Materials and Construction Details and Specifications

Applications	Telecom, Utilities, Petro-Chemical, Rail and Transportation, Environmental Monitoring, Energy Oil and Gas, Government Buildings, Manufacturing, Military, Mining,
Wall and Roof Materials	12 and 14 gauge galvanized steel, non-combustible rock wool insulation
Standard Floor Material	Hot-rolled, galvanized steel diamond plate (3/16" thick)
Building Weight (as shown)	Approx 6,500 lbs (for standard 10'W x 8'D configuration shown below)
Building Height Options	8' / 10' Heights
Standard Sizes	8' / 10' / 12' Widths; Lengths in N x 2-foot increments
Exterior Dimensions	125.3" W x 101.22" D x 136.68" H (includes 8" skid height) *depth varies in 2' increments and value shown is standard for 10' height x 8' deep configuration
Interior Dimensions	110" W x 86" D x 114" H *depth varies in 2' increments and value shown is standard for 10'W x 8'D x 10'H configuration shown below
Standard Door Size	36" W x 84" H: Keyed entry, panic exit with closer. Door window is fixed, tempered glass, single pane
Wall Unistrut/Studs	Stud construction: B22 1-5/8" x 1-5/8" solid steel Unistrut (back-to-back with thermal spacer), 24" O.C.
Ceiling Unistrut/Framing	Rafter construction: P5500 1-5/8" x 2-7/16" solid steel Unistrut, 24" O.C.
Wall Insulation	Rock Wool (non-combustible fire-resistant up to 2150° F)
Paint and Color Choices	Triglycidyl Isocyanurate (TGIC) polyester powder coat available in white, tan, and gray
Standards	Suitable for Class 1, Division 1 and 2, Groups A, B, C, D, E, F, and G. {OSHA 1910.307 "Hazardous (classified) locations"} Conforms to NFPA 70 National Electrical Code Typically not subject to Industrialized Building Standard 1* (No "Closed Construction")
Wind Load Rating	150 mph
Snow Load	60 lb/sq ft
Overall R-Value	15
NEMA Rating	3R
Flammability	All walls, ceiling, floor flame rating: 0 (non-combustible), fire-resistant (Class A) roof
Wall (Unistrut) Attachment Load Limit	Max Allowable Moment = 5,070 In-lbs per attachment point
Full Depth Fork Pockets; Hard attachment points	All sizes: 3"x8" structural C-channel (3"x8" opening). Includes 4 "Lifting Eyes" mounted to skid corners

Note 1: Closed Construction Structure: A construction that cannot be inspected (electrical, plumbing, etc) at the construction site for building code compliance

## Common Accessories and Options

- Interior wall with vapor barrier
- Universal wall-bulkhead insert
- Interior/exterior light fixtures
- Electrical service panel package
- Gutters, shelves, and awnings

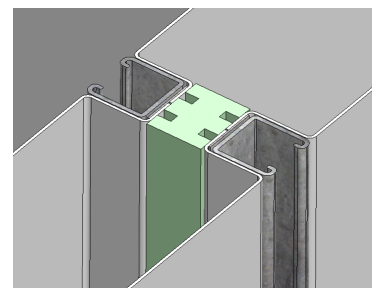
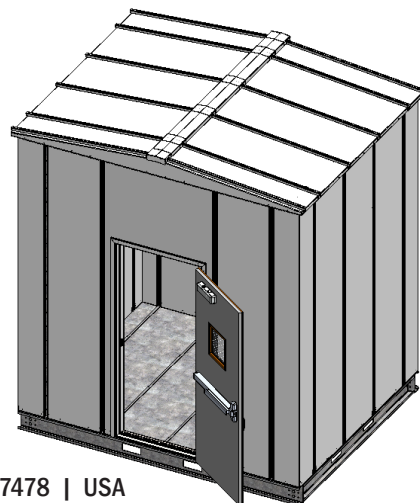

ISNetworld 400-255542

877.340.1224 toll free | [www.solarcraft.net](http://www.solarcraft.net)

12300 Dairy Ashford Road Ste 100 | Sugar Land, Texas 77478 | USA